

***BATTERY DISCONNECT
SWITCHES***

About Us

Aopec was founded in the year of 2003, focus on automotive parts for more than 10 years. Year 2006, invested in manufacturing Automotive Relay and Battery Management System to OE customers. April, 2013, Aopec USA LLC. was set up in CA, to be with our customers in NA to make a valuable cost down plan, Walmart, Autozone is working well together.

It is not only a premium manufacturer both in direct investment and joint ventures for Automotive Electrics, but also carrying a big range of aftermarket parts, with more than 500 selected partners under 30 categories in China. TS standardized QC control with the lean manufacturing process, Global Supply Chain Management and One-Stop Solution make Aopec a reliable partner with the customers on design, quality, delivery and services.

Aftermarket - The range of body parts for most vehicle application in the market.
 OE - Automotive Relay / Battery Isolator Switch / Battery Charger / Auto Switch/Marine Switch/Race Switch

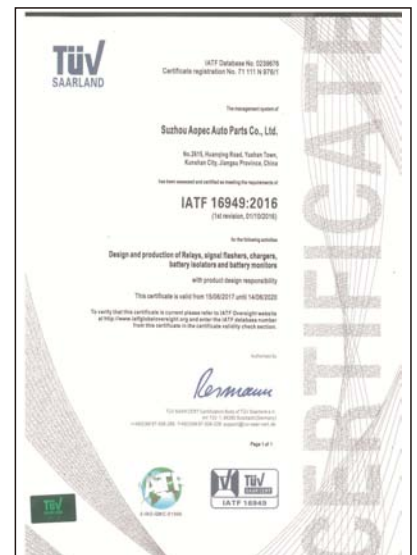

AOPEC

www.aopec.com

To continue to meet the growing automobile accessories and services, we are always struggling.



www.aopec.com



To meet every customers' high requirement,
Do our best to create product and service.

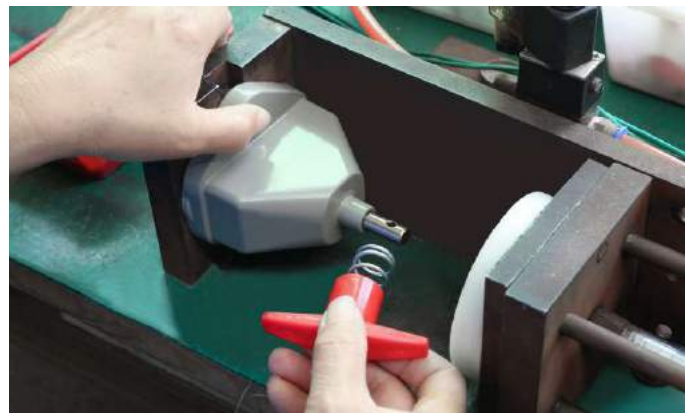



APC001

Voltage: 12/24V
Continuous current: 50/100A
Transient current: 500A(5S)
Working temp: -40°C +80°C

UNIVERSAL

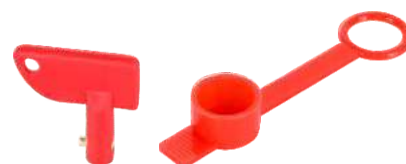
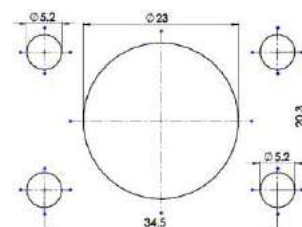

APC001D

Voltage: 12/24V
Continuous current: 50/100A
Transient current: 500A(5S)
Working temp: -40°C +80°C

UNIVERSAL

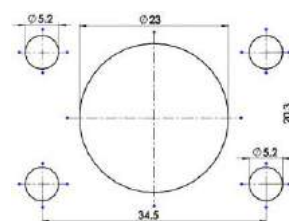

APC002

Voltage: 12/24V
Continuous current: 50/100A
Transient current: 500A(5S)
Working temp: -40°C +80°C

UNIVERSAL

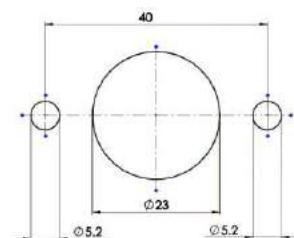

APC002D

Voltage: 12/24V
Continuous current: 50/100A
Transient current: 500A(5S)
Working temp: -40°C +80°C

UNIVERSAL

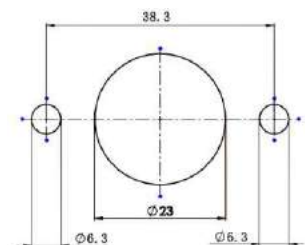



APC003

Voltage: 12/24V
 Continuous current: 200A
 Transient current: 1000A(5S)
 Working temp: -40°C +80°C

HOWO

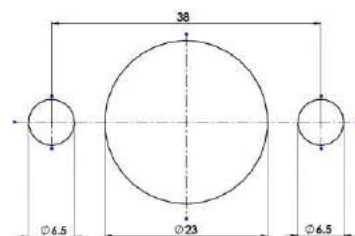

APC004

Voltage: 12/24V
 Continuous current: 75/200A
 Transient current: 1000A(5S)
 Working temp: -40°C +85°C

SKODA 193915060 FORD

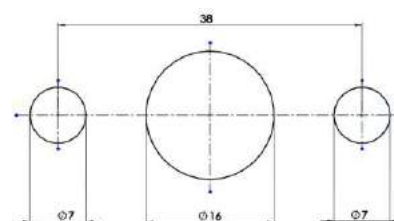

APC005

Voltage: 12/24V
 Continuous current: 75/200A
 Transient current: 1000A(5S)
 Working temp: -40°C +85°C

SKODA
 193915060
 FORD

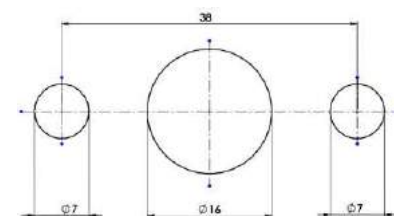

APC006

Voltage: 12/24V
 Continuous current: 150A
 Transient current: 1000A(5S)
 Working temp: -40°C +85°C

443815432010
 E9341915061
 ZETOR TATRA

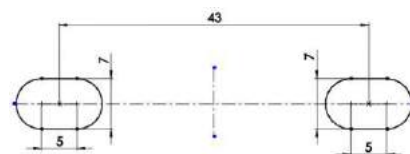



APC006B

Voltage: 12/24V
 Continuous current: 150A
 Transient current: 1000A(5S)
 Working temp: -40°C +80°C

443815432010
 E9341915061
 ZETOR TATRA

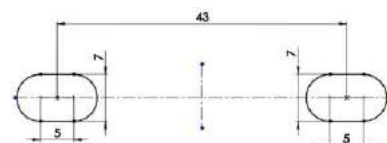

APC007

Voltage: 12/24V
 Continuous current: 250/350A
 Transient current: 2000A(5S)
 Working temp: -40°C +85°C

443815432020
 E9341915061
 ZETOR TATRA

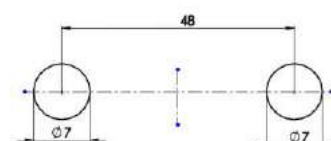

APC008

Voltage: MAX 48VDC
 Continuous current: 250/350A
 Transient current: 1000A(10S)
 Working temp: -40°C +85°C

E9341915060

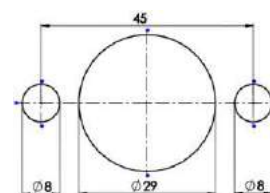

APC009

Voltage: MAX 48VDC
 Continuous current: 250A
 Transient current: 2500A(5S)
 Working temp: -40°C +85°C

BOSCH 0341002003
 VOLVO 240315,6884875
 SCANIA 621730

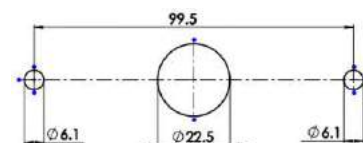



APC009C

Voltage: MAX 48VDC
 Continuous current: 400A
 Transient current: 3500A(5S)
 Working temp: -40°C +85°C

BOSCH 0341002003
 VOLVO 240315,6884875
 SCANIA 621730

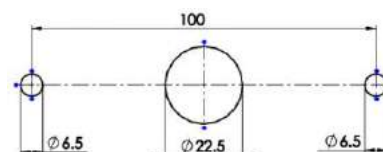

APC010

Voltage: MAX 48VDC
 Continuous current: 250A
 Transient current: 2500A(5S)
 Working temp: -40°C +85°C

BOSCH 0341002003
 VOLVO 240315,6884875
 SCANIA 621730



APC010C

Voltage: MAX 48VDC
 Continuous current: 250A
 Transient current: 2500A(5S)
 Working temp: -40°C +85°C

BOSCH 0341002003
 VOLVO 240315,6884875
 SCANIA 621730

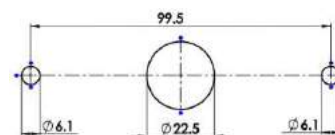

APC011

Voltage: 12/24V
 Continuous current: 150A
 Transient current: 1000A(5S)
 Working temp: -40°C +85°C

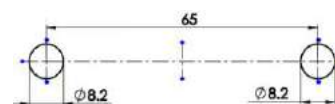



APC012

Voltage: MAX 48VDC
 Continuous current: 450A
 Transient current: 4500A(5S)
 Working temp: -40°C +85°C

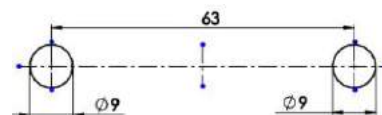

MR2200100B



APC013

Voltage: MAX 48VDC
 Continuous current: 300A
 Transient current: 3000A(5S)
 Working temp: -40°C +85°C

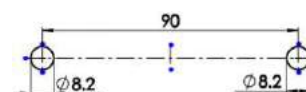

APC014

Voltage: 12/24V
 Continuous current: 150/200A
 Transient current: 1000A(5S)
 Working temp: -40°C +85°C

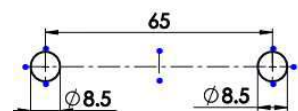

372B1-36010
 TIANLONG



APC015

Voltage: MAX 48VDC
 Continuous current: 150/200/350A
 Transient current: 2500A(5S)
 Working temp: -40°C +85°C

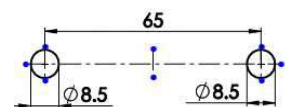

STEYR 034130021
 MAN
 VOLVO 1589297



APC015B

Voltage: MAX 48VDC
 Continuous current: 400A
 Transient current: 3500A(5S)
 Working temp: -40°C +85°C

BOSCH 0341002003
 VOLVO 240315,6884875
 SCANIA 621730

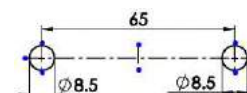

APC015C

Voltage: MAX 48VDC
 Continuous current: 400A
 Transient current: 3500A(5S)
 Working temp: -40°C +85°C

IVECO MAGIRUS 4822229
 COBO 13001000
 FORD CARGO 8C46-14526-AA

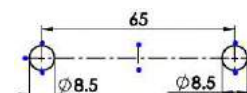

APC016

Voltage: MAX 48VDC
 Continuous current: 300/500A
 Transient current: 2500A(5S)
 Working temp: -40°C +85°C

IVECO MAGIRUS 4822229
 COBO 13001000
 FORD CARGO 8C46-14526-AA

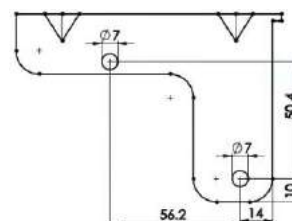

APC016-3

Voltage: MAX 48VDC
 Continuous current: 300/500A
 Transient current: 2500A(5S)
 Working temp: -40°C +85°C

IVECO MAGIRUS 4822229
 COBO 13001000
 FORD CARGO 8C46-14526-AA

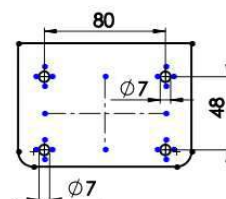



APC017

Voltage: MAX 48VDC
 Continuous current: 300/500A
 Transient current: 2500A(5S)
 Working temp: -40°C +85°C

IVECO MAGIRUS 4822229
 COBO 13001000
 FORD CARGO 8C46-14526-AA

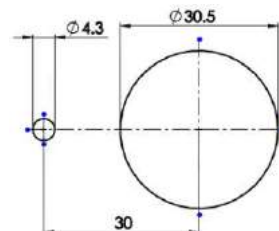

APC018

Voltage: 12/24V
 Continuous current: 200A
 Transient current: 1000A(5S)
 Working temp: -40°C +85°C

HOWO

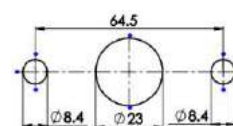

APC019

Voltage: 12/24V
 Continuous current: 150A
 Transient current: 1000A(5S)
 Working temp: -40°C +85°C

MERCEDES

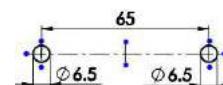

APC020

Voltage: 12/24V
 Continuous current: 200A
 Transient current: 1000A(5S)
 Working temp: -40°C +85°C

Ordnance 8339369 UCOM#4813
 NSN:5930-00-930-5016
 MS-27200-1;QPL#8523
 MIL-S-13625/2-1

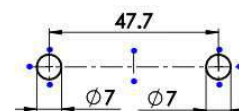



APC020

Voltage: 12/24V
Continuous current: 50/150A
Transient current: 1000A(5S)
Working temp: -40°C +85°C

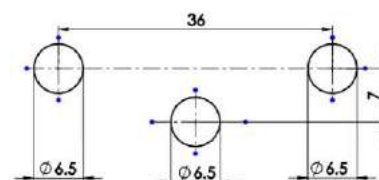

VOLGA,KAMAZ
BK3185



APC022

Voltage: MAX 48VDC
Continuous current: 300A
Transient current: 2000A(5S)
Working temp: -40°C +85°C

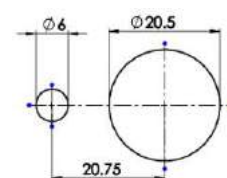

APC022B

Voltage: MAX 48VDC
Continuous current: 300A
Transient current: 2000A(5S)
Working temp: -40°C +85°C

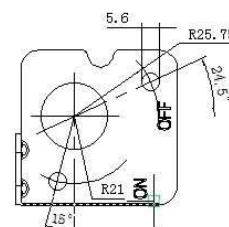

APC022C

Voltage: MAX 48VDC
Continuous current: 300A
Transient current: 2000A(5S)
Working temp: -40°C +85°C

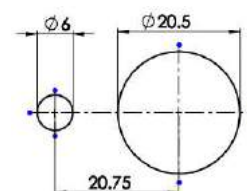



APC023

Voltage: 12/24V
Continuous current: 300A
Transient current: 1000A(5S)
Working temp: -40°C +85°C

IFA W50

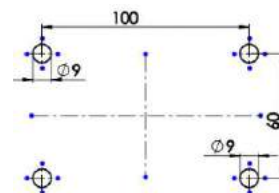

APC024

Voltage: 12/24V
Continuous current: 100A
Transient current: 1000A(5S)
Working temp: -40°C+85°C

D813
ZETOR 89350916

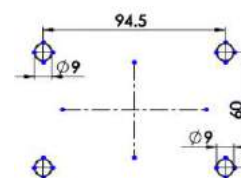

APC025

Voltage: 12/24V
Continuous current: 500A
Transient current: 5000A(5S)
Working temp: -40°C+85°C

D818

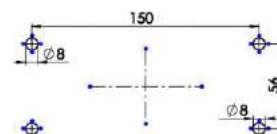

APC026

Voltage: 12/24V
Continuous current: 150A
Transient current: 1000A(5S)
Working temp: -40°C +85°C

MITSUBISHI

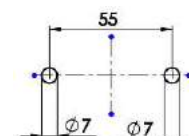



APC027

Voltage: 12/24V
 Continuous current: 200A
 Transient current: 1000A(5S)
 Working temp: -40°C +85°C

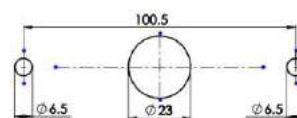

APC028

Voltage: 12/24V
 Continuous current: 100A
 Transient current: 500A(5S)
 Working temp: -40°C +85°C

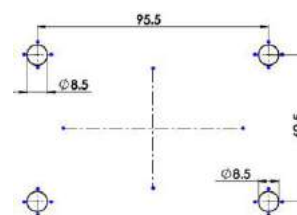

IVECO



APC029

Voltage: 12/24V
 Continuous current: 200A
 Transient current: 1500A(5S)
 Working temp: -40°C +85°C

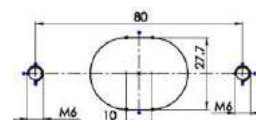

VOLVO 21243844

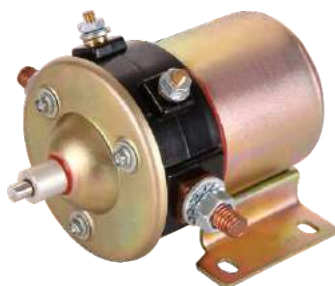

APC030

Voltage: 12/24V
 Continuous current: 100A
 Working temp: -40°C +85°C

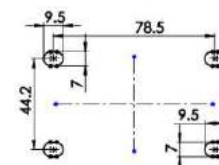



APCSP001



APCSP002



APCSP003



APCSP004



APCSP005



APCSP006



APCSP007



APCSP008



APCSP009



APCSP010



APCSP011



APCSP012



APCSP013



APCSP014



APCSP015



APCSP016



APCSP017



APCSP018



APCSP019



APCSP020



APCSP021



APCSP022



APCSP023



APCSP024



APCSP025



APCSP026



APCSP027



APCSP028



APCSP029



APCSP030



APCSP031



APCSP032

One Lens



Two Lens



No Lens



Laser Engraving





APC3011



APC3014



APC3015



APC3016



APC3017



APC3019

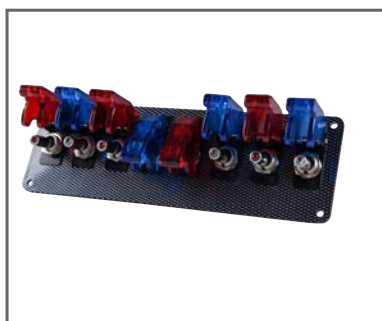

APC3020



APC3021

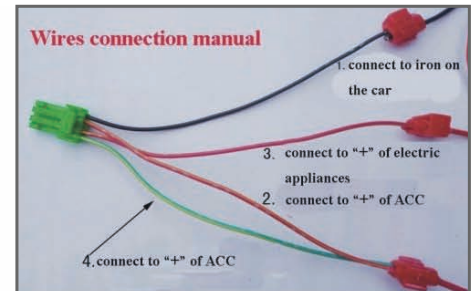

The symbols on cover can be chosen in our catalogue or laser etching any drawings on request.

For Led light color, 5 colors optional



WHITE



ORANGE



GREEN



RED



BLUE

Item Number	Vehicle Type	Size	Product Details
APC-PBS-T001	NEW STYLE TOYOTA	32MMX20MMX52MM	*Rated at 3Amp 12V, single pole single throw ON-OFF push switch *Uses the original mounting hole of the vehicle *Wiring diagram: Blue and red wires should be connected to ACC positive, Green wire should be connected to positive, Black wire should be connected to negative.
APC-PBS-T002	OLD STYLE TOYOTA	40MMX20MMX61MM	
APC-PBS-N001	NISSAN	55MMX44MMX20MM	
APC-PBS-M001	MITSUBISHI	60MMX37MMX22MM	
APC-PBS-H001	HONDA	57MMX40MMX20MM	

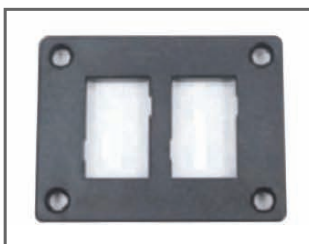



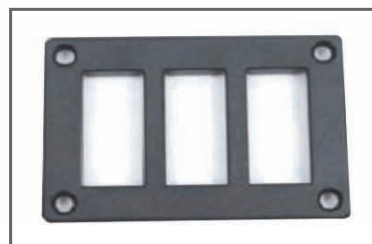



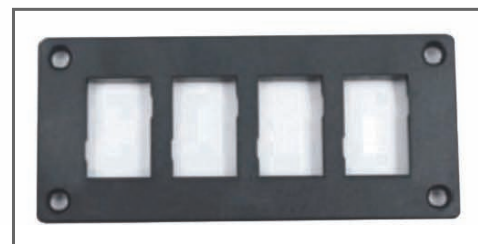

TWO HOLE PANEL



THREE HOLE PANEL



FOUR HOLE PANEL

Pat.No	Picture	Applicable models	Size(mm)
APC-T1		AVANZA VIGO FORTUNER VIOS	37.7(L)*20.7(W)
APC-T2		CAMRY COROLLA LAND CRUISER AXIO BELTA VIOS YARIS RAV4	31.4(L)*20.9(W)
APC-T3		MITSUBISHI LANCER VITZ COROLLA ATLAS SCION TC ETIOS	42.7(L)*24.3(W)
APC-T4		CIVIC	44.94(L)*23.7(W)
APC-T5		AMAROK	43.0(L)*27.0(W)
APC-T5A		AMAROK	30.3(L)*26.0(W)
APC-T6		ISUZU D-MAX old ISUZU switch is fit up to 2012	38.6(L)*21.4(W)
APC-T6A		ISUZU D-MAX new ISUZU fits 2013+	33.0(L)*22.2(W)
APC-T7		CIVIC	38.5(L)*23.0(W)

Dual USB Car Charger



APC-T001
 OLD TOYOTA
 Size:40*20mm
 Input:12-24V
 USB Output:5V 4.2A

USB With Audio Car Charger



APC-T002
 OLD TOYOTA
 Size:40*20mm
 Input:12-24V

USB With Led Digital Voltmeter



APC-T001A
 OLD TOYOTA
 Size:40*20mm
 Input:12-24V
 USB Output:5V 2.1A

Voltage and Temperature Display



APC-T002A
 NEW TOYOTA
 Size:32*20mm
 Input:12-24V

Dual USB Car Charger for Toyota



APC-T002B
 NEW TOYOTA
 Size:43*25mm
 Input:12-24V
 USB Output:5V 3.1A

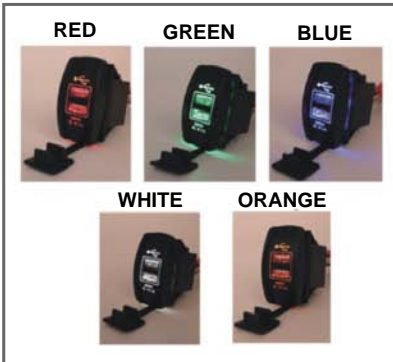

APC-T004
 Size: 48.5*24.5mm
 Input:12-24V
 USB Output:5V 3.1A



APC-T004A
 Size: 40*23mm
 Input:12-24V
 USB Output:5V 3.1A



APC-T005
 Size: 32*28mm
 Input:12-24V
 USB Output:5V 3.1A



APC-T006
 Size: 32*28mm
 Input:12-24V
 USB Output:5V 3.1A



APC-T007
 Size: ϕ 28.6mm
 Input:12-24V
 USB Output:5V QC3.0



APC-T008
 Size:44*34mm
 Input:12-24V
 USB Output:5V 4.2A



APC-042



APC-043



APC-044



APC-045



APC-046



APC-046A



APC-047



APC-048



APC-049



APC-050



APC-051



APC-052



APC-053



APC-054



APC-055



APC-056



APC-057



APC-058



APC-059



APC-060



APC-061



APC-062



APC-063



APC-064



APC-065



APC-066



APC-067



APC-068



APC-069

AOPEC



No.2615 Huanqing Rd.
Kunshan Suzhou 215300 China



Tel: +86 512 8616 0118
Fax: +86 512 8616 0078



E-mail: sales@aopec.com

www.aopec.com